

Saxton Lane, LS9

PROPERTY ADDRESS
B313
Phoenix Saxton Lane
Leeds
LS9 8GH

Energy Efficiency Rating		Current	Potential
Very energy efficient - lower running costs			
(92 plus) A			
(81-91) B		85	85
(69-80) C			
(55-68) D			
(39-54) E			
(21-38) F			
(1-20) G			
Not energy efficient - higher running costs			
England & Wales	EU Directive 2002/91/EC		

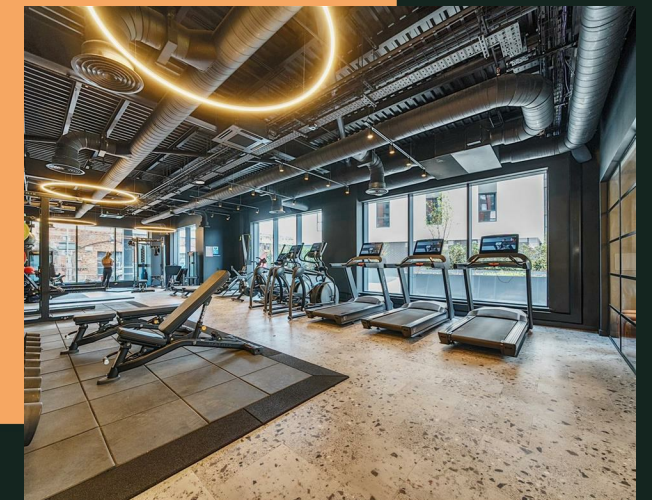
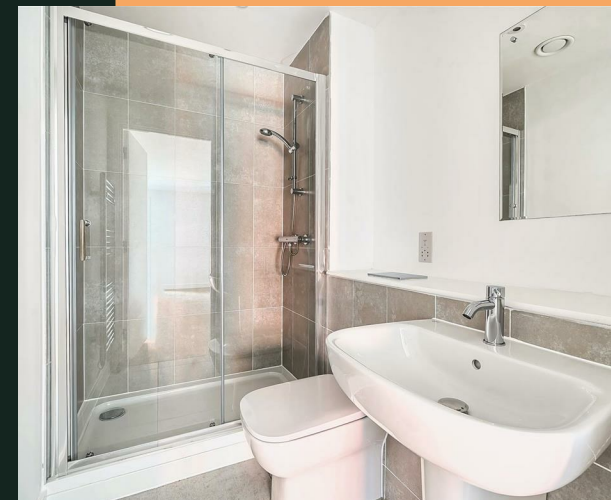

Call Us
01132440251

Email Us
leeds@vision-properties.co.uk

vision

We look at
estate agency
differently.

vision

- Total cost of first month: £2,692.30 (rent & deposit)
- Excellent location
- Furnished
- Concierge
- Gym

Vision Properties are delighted to present this modern two bedroom apartment in the popular Phoenix development.

This recently-built apartment will come furnished. It benefits from high spec fixtures and fittings throughout and has floor-to-ceiling windows with stunning views of the Leeds skyline. It briefly comprises of a bright and airy open plan living, kitchen and dining area with integrated appliances, two double bedrooms and two bathrooms (one is an ensuite).

The Phoenix building is in a great location, close to all the amenities and transport links of the city centre. The development offers numerous facilities for residents including a concierge service, gym and communal courtyard.

Available from 6th August subject to acceptable referencing.

Rent: £1,250 per calendar month
 Holding deposit: £288.46
 Deposit: £1,442.30

Please note the furniture has been virtually staged using CGIs for illustration.



2 bedroom Apartment £1,250 PCM

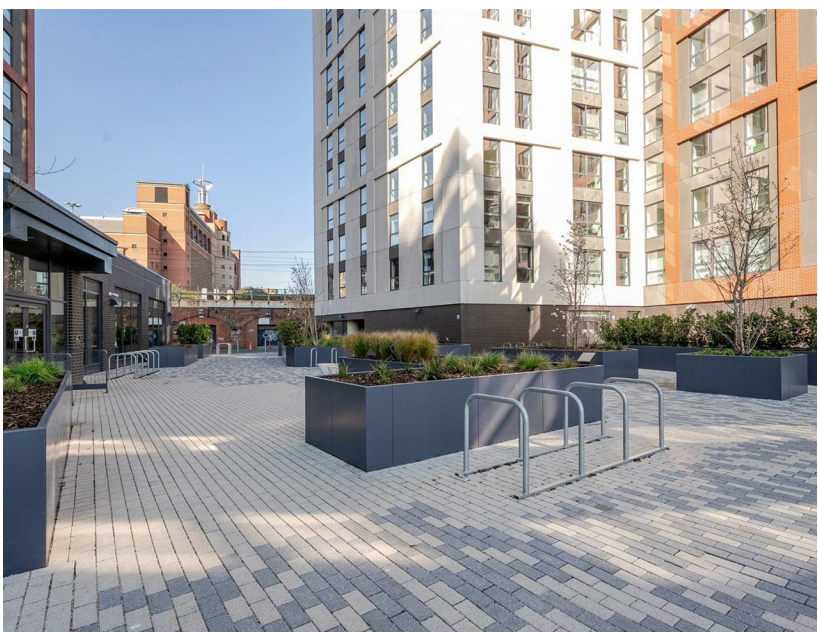
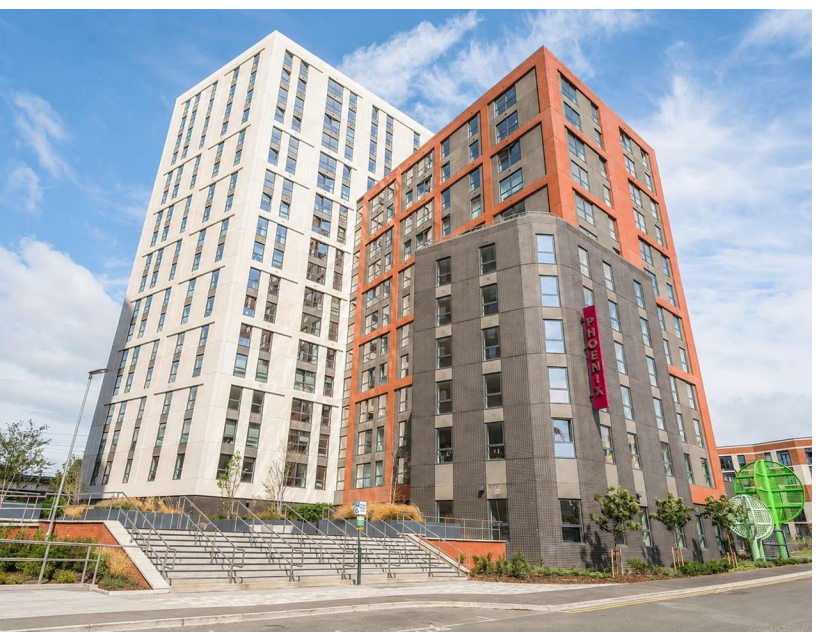

This recently-built apartment will come furnished. It benefits from high spec fixtures and fittings throughout and has floor-to-ceiling windows with stunning views of the Leeds skyline. It briefly comprises of a bright and airy open plan living, kitchen and dining area with integrated appliances, two double bedrooms and two bathrooms (one is an ensuite).

The Phoenix building is in a great location, close to all the amenities and transport links of the city centre. The development offers numerous facilities for residents including a concierge service, gym and communal courtyard.

Available from 6th August subject to acceptable referencing.

Rent: £1,250 per calendar month
 Holding deposit: £288.46
 Deposit: £1,442.30

Please note the furniture has been virtually staged using CGIs for illustration.